



RCA VICTOR

WELLS
8-in-One Turntable Music
Center with AudioStream™

RWRP-4000



Instruction Manual

Please read carefully before use and keep for future reference

WARNING



CAUTION: To reduce the risk of fire or electric shock, do not expose this appliance to rain or moisture.



WARNING: Invisible laser radiation when open and interlock failed or defeated. Avoid direct exposure to laser beam.



This equipment is a Class II or double insulated electrical appliance. It has been designed in such a way that it does not require a safety connection to electrical earth.



Correct Disposal of this product. This marking indicates that this product should not be disposed with other household wastes throughout the EU. To prevent possible harm to the environment or human health from uncontrolled waste disposal, recycle it responsibly to promote the sustainable reuse of material resources. To return your used device, please use the return and collection systems or contact the retailer where the product was purchased. They can take this product for environmental safe recycling.

Important Safety Instructions

1. Read these instructions – All the safety and operating instructions should be read before this product is operated.
2. Keep these instructions – The safety and operating instructions should be retained for future reference.
3. Heed all warnings – All warnings on the appliance and in the operating instructions should be adhered to.
4. Follow all instructions – All operating and use instructions should be followed.
5. Do not use this apparatus near water – The appliance should not be used near water or moisture – for example, in a wet basement or near a swimming pool, and the like.
6. Clean only with a dry cloth.
7. Do not block any ventilation openings. Install in accordance with the manufacturer's instructions.
8. Do not install near any heat sources such as radiators, heat registers, stoves, or other apparatus (including amplifiers) that produce heat.
9. Protect the power cord from being walked on or pinched particularly at the plugs, power outlets, and at the point where they exit from the apparatus.
10. Only use attachments/accessories specified by the manufacturer.
11. Use only with the cart, stand, tripod, bracket, or table specified by the manufacturer, or sold with the apparatus. When a cart or rack is used, use caution when moving the cart/apparatus combination to avoid injury from tip-over.
12. Unplug the apparatus during lightning storms or when unused for long periods of time.
13. Refer all servicing to qualified personnel. Servicing is required when the apparatus has been damaged in any way, such as power supply cord or plug is damaged, liquid has been spilled or objects have fallen into the apparatus has been exposed to rain or moisture, does not operate normally, or has been dropped.
14. The mains plug is used as disconnect device, the disconnect device shall remain readily operable.
15. **WARNING:** To reduce the risk of fire or electric shock, do not expose this apparatus to rain or moisture. The apparatus shall not be exposed to dripping or splashing and that no objects filled with liquids, such as vases, shall not be placed on apparatus.
16. The use of the equipment in moderate climate.
17. The ventilation should not be impeded by covering the ventilation openings with items, such as newspapers, tablecloths, curtains, etc.
18. Do not place open flame sources, such as lighted candles, on the apparatus.
19. The symbol with  indicates AC voltage.
20. **CAUTION,** These servicing instructions are for use by qualified service personnel only. To reduce the risk of electric shock do not perform any servicing other than that contained in the operating instructions unless you are qualified to do so.



This lightning flash with arrowhead symbol within an equilateral triangle is intended to alert the user to the presence of non-insulated "dangerous voltage" within the product's enclosure that may be of sufficient magnitude to constitute a risk of electric shock. Warning: To reduce the risk of electric shock, do not remove cover (or back) as there are no user-serviceable parts inside. Refer servicing to qualified personnel. The exclamation point within and equilateral triangle is intended to alert the user to the presence of important operating and maintenance instructions in the literature accompanying the appliance.



TABLE OF CONTENTS

FEATURES	3
SPECIFICATIONS	3
PRODUCT OVERVIEW	4
SET UP & BASIC OPERATION	6
COPYING/ENCODING INSTRUCTIONS	11
TROUBLESHOOTING GUIDE.....	15
MAINTENANCE.....	16
FCC NOTICE	18
CAUTION ON MODIFICATION.....	19
SUPPORT.....	19

FEATURES

Experience the Wells 8-in-1 Turntable Music Center with AudioStream™. This powerful system brings all your media to life—spin vinyl records, play cassette tapes, enjoy CDs, and tune into AM/FM radio. With Dual Bluetooth®, you can stream from your phone or broadcast your classic media wirelessly. The built-in recorder lets you digitize your entire collection from vinyl, CDs, or cassettes directly to USB/SD. With powerful 20W stereo sound, it's the complete hub for music lovers.

- **3-SPEED TURNTABLE** – Enjoy your favorite records with a turntable that supports all three speeds: 33-1/3, 45, and 78 RPM.
- **AUDIOSTREAM™ (Bluetooth Out)**
AUDIOSTREAM™ lets you wirelessly stream audio from this system to external Bluetooth speakers, earphones, headphones. In other words, AUDIOSTREAM™ is our branded name for the Bluetooth output feature. This is different from the Bluetooth® input function, which lets you play music from your smart device to this system. Thus, this device allows you to both wirelessly stream music into (i.e., Bluetooth In) or out of (i.e., Bluetooth Out) the device for your enjoyment.
- **Bluetooth®** – Stream music wirelessly from your smart device with Bluetooth connection.
- **STEREO CASSETTE TAPE DECK** – Play and record your favorite mixtapes and albums on the built-in cassette player, adding a warm, nostalgic sound to your listening experience.
- **Programmable CD Player & Digital Recorder** – Enjoy your CDs with programmable play settings and easily digitize your entire collection—from vinyl, CDs, cassettes, or any Aux source—directly to a USB drive or SD card.
- **AM/FM Radio & Powerful Sound** – Tune in to your favorite AM or FM radio stations and enjoy it all through a powerful 20W stereo speaker system for room-filling audio.

SPECIFICATIONS

Product Name	WELLS 8-in-One Turntable Music Center with AudioStream™
Turntable Speed	33 1/3, 45, 78 RPM
FM Frequency Range	87.5 to 108 MHz
FM Station Memory	Up to 20
AM Frequency Range	520 to 1710 KHz
AM Station Memory	Up to 10
Bluetooth® Version	5.0
Bluetooth® Frequency	2.40 GHz
Bluetooth® Operating Distance	Up to 33 Feet (10 Meters)*
Input	Aux In, USB, SD Memory Card, Cassette, CD
Output	AudioStream™ (Bluetooth Out), Speaker Out, Headphone Jack
External Speakers	4" x 2
Speaker Output Power	10W x 2
Power Source	AC 100-240V 50-60Hz
Accessories Included	ETL Power Adapter, Remote Control (2 x AAA Batteries Not Included), User Manual, Quick Start Guide, Felt Slipmat, Warranty Card

*Distance may vary depending on any objects or interference between devices.

SPECIFICATIONS AND ACCESSORIES ARE SUBJECT TO CHANGE WITHOUT NOTICE

PRODUCT OVERVIEW

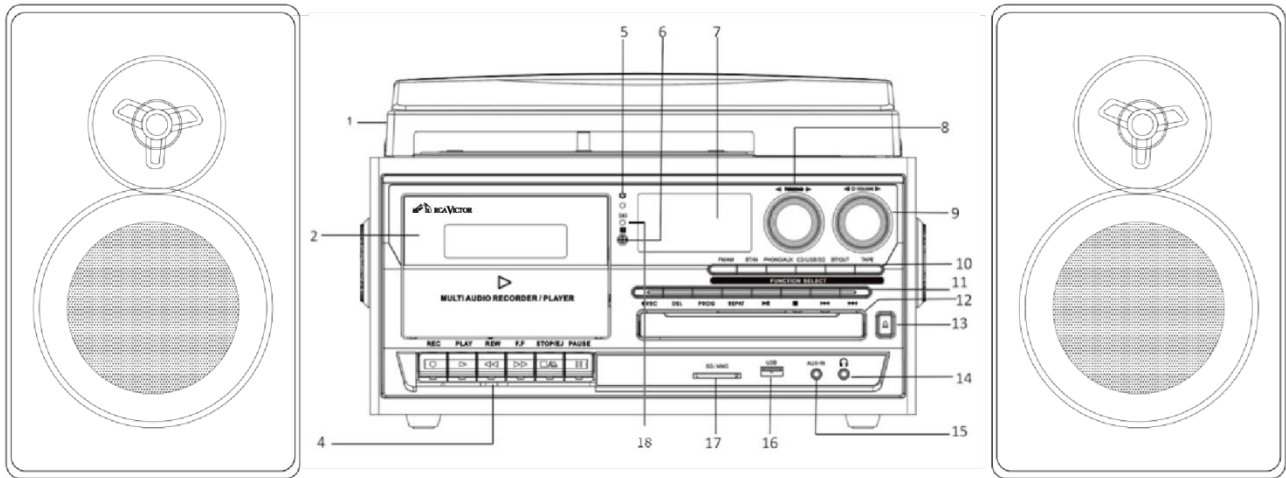

- | | |
|-------------------------------|--|
| 1) Dust Cover | 10) Function Selector Button |
| 2) Cassette Door | (AM/FM, BT/IN, PHONO/AUX, CD/USB/SD, BT/OUT, TAPE) |
| 3) External Speaker | 11) CD/USB/SD Playback Control Button |
| 4) Cassette Buttons | 12) Disk Tray Door |
| 5) Power LED Indicators | 13) CD-ROM Open/close button |
| 6) IR Remote Receiver | 14) 3.5mm Headphone Jack |
| 7) LCD Display Screen | 15) Auxiliary Input |
| 8) Tuning Knob | 16) USB port |
| 9) Power Switch & Volume Knob | 17) SD/MMC Card Slot |
| | 18) BT/OUT LED Indicator |

PHONOGRAPH

- 19) 45 RPM Adaptor
- 20) Lift Lever
- 21) Auto Stop Control
- 22) Tone Arm lock
- 23) Speed Selector (33/45/78 RPM)
- 24) Tone Arm

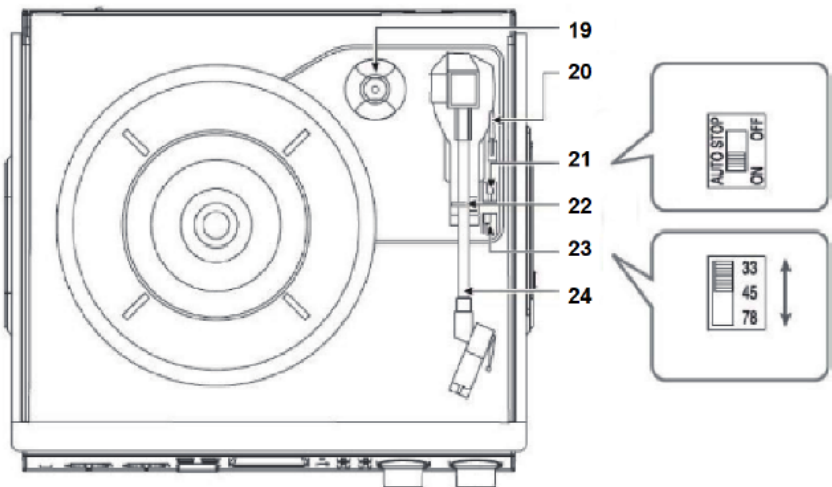

PRODUCT OVERVIEW

BACK PANEL

- 25) Speaker Jack
- 26) FM Wire Antenna
- 27) DC Power Jack

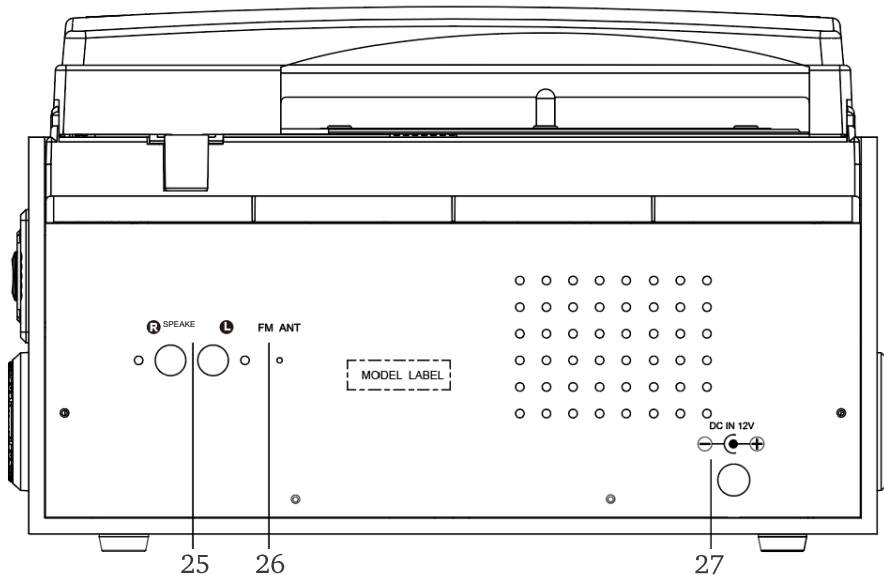

REMOTE CONTROL

- 28) Power STANDBY/ON
- 29) Mode: AM/FM, BT/IN, PHONO/AUX, CD/USB/SD, TAPE
- 30) CD/USB/SD Repeat One/All
- 31) CD/USB/SD Skip down, RADIO preset skip down
- 32) STOP
- 33) Record: Phono to USB/SD Encoding. CD to USB/SD encoding
- 34) Volume Down
- 35) Mute
- 36) Volume Up
- 37) CD MP3/USB/SD Folder up select, AM/FM Radio Tuning Up
- 38) CD MP3/USB/SD Folder Down Select, AM/FM Radio Tuning Down
- 39) Play/Pause
- 40) CD/USB/SD Skip Up, RADIO Preset Skip Up
- 41) BT/OUT (AUDIOSTREAM™)

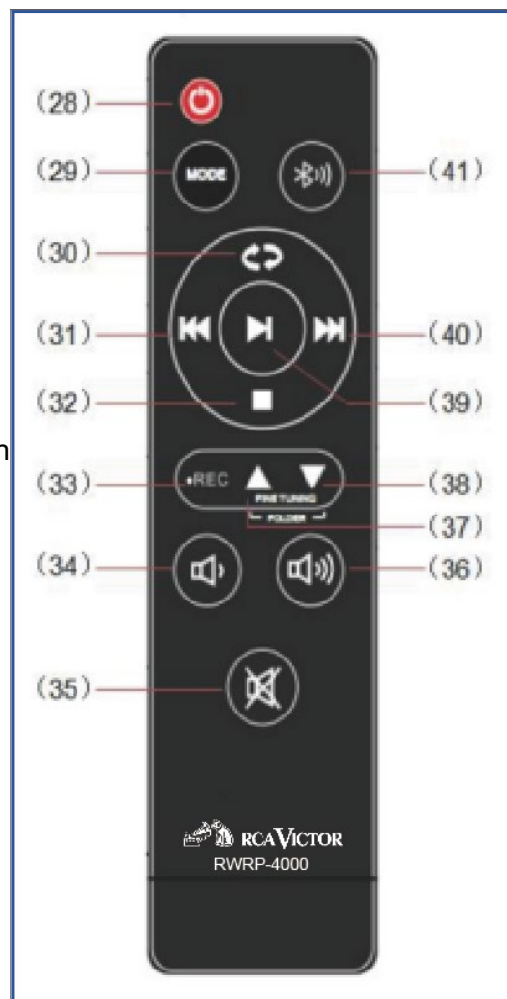

SET UP & BASIC OPERATION

Unpacking and Setup

- 1) Carefully remove the unit from the display carton and remove all packing material from the unit.
- 2) Unwind the AC power cord and extend it to its full length.
- 3) Unwind the FM Antenna wire and extend it to its full length.
- 4) Place the unit on a stable, level surface, convenient to an AC outlet, out of direct sunlight, and away from sources of excess heat, dust, moisture, humidity or strong magnetic fields.
- 5) Remove the opaque white plastic stylus cover from the phonograph stylus by sliding it forward and down.
- 6) Discard the stylus cover
- 7) Remove the twist-tie that was used to secure the tone arm during shipment.
- 8) Release the tone arm lock lever.
- 9) Connect the plug to your AC outlet.

Power Source

This product is designed to operate on 100–240V, 50–60Hz AC power only. Attempting to operate this system using any other power source may damage the unit. Damage caused by improper power sources is not covered by the warranty.

Protect Your Furniture

This model is equipped with non-skid rubber feet to prevent movement during operation. These feet are made from a non-migrating rubber material designed to avoid leaving marks or stains on furniture.

However, certain oil-based furniture polishes, wood preservatives, or cleaning sprays may cause the rubber feet to soften and leave marks or residue on furniture surfaces. To prevent possible damage, we strongly recommend placing self-adhesive felt pads (available at most hardware or home improvement stores) on the bottom of the rubber feet before placing the product on fine wooden furniture.

OPERATION

Bluetooth® In Operation

- 1) Press the BT/IN button on the RWRP-4000 to enter Bluetooth mode.
- 2) On your external device (such as a smartphone or tablet), turn on Bluetooth and set it to pairing mode.
- 3) Select “RWRP-4000” from the list of available Bluetooth devices.
- 4) When the connection is successful, “BT” on the RWRP-4000 LCD display will change from flashing to solid.

AUDIOSTREAM™ Operation

Transmit audio from the unit via Bluetooth® Out

- 1) Start playback on the RWRP-4000, then press the BT/OUT button.
- 2) Turn on the receiving device (such as Bluetooth® speakers or headphones) and enable Bluetooth pairing mode. 
- 3) The receiving device will automatically connect to RWRP-4000.
(Note: Some receiving devices may require you to confirm or select the connection to receive audio from the RWRP-4000.)
- 4) When the Bluetooth® connection is successful, the transmission indicator light on the unit will change from flashing to solid.
- 5) Adjust the volume on the unit or on the connected device to the desired level.

D`Umjb[`5i X]c `Zca `UI G6 `8 Yj]W`cf `G8 `7 UfX

The system can decode and play MP3 and WMA files stored on a USB device or an SD/MMC card connected to the unit.

- 1) Tap the POWER/VOLUME knob to turn the unit on.
- 2) Insert a USB device face up into the USB port, making sure it is fully inserted.
– OR –
Insert a memory card into the SD/MMC card slot in the direction of the arrow shown on the label, ensuring it is inserted straight and not bent.
- 3) Set the function selector to USB/SD mode.
 - If both a USB device and an SD card are inserted, press the MODE button to switch between USB and SD modes.
 - The system will automatically read the selected storage device and display the total number of folders and MP3/WMA files.
- 4) Audio playback will begin automatically from the selected USB device or SD card.

IMPORTANT: Inserting a USB device or memory card upside down or backwards may damage the audio system or the storage media (USB drive, SD card, or MMC card). Always check that the device or card is oriented correctly before inserting it.



USB/SD Playback Controls

- **PLAY/PAUSE:** Press once to pause playback. Press again to resume playback.
- **STOP:** Press to stop audio playback. The display will show the total number of MP3/WMA files.
- **SKIP UP:** Press once to skip to the next file. Press and hold to fast forward through the current track.
- **SKIP DOWN:** Press once to return to the previous file. Press and hold to fast rewind through the current track.
- **REPEAT (CD/USB/SD):** Press repeatedly to select Repeat One or Repeat All playback modes.

OPERATION

Removing the USB Device

- First, switch the function selector to another mode (Tuner, Phono, or Tape), then tap the POWER/VOLUME knob to turn the unit off.
- To remove a USB device, pull it straight out of the USB port.

Important Notes

- The system can detect and play MP3 and WMA files only when using the USB port or SD card slot.
- You may connect an MP3 player to the system via the USB port; however, some MP3 players may not be compatible. This is due to differences in MP3 encoding formats and does not indicate a malfunction of the system.
- Because USB drives and SD cards vary by manufacturer and format, compatibility with all USB and SD devices cannot be guaranteed.
- This system supports SD cards up to 8 GB.

Supported Audio Format Requirements:

- MP3 bit rate: 32 kbps~256 kbps
- WMA bit rate: 32 kbps ~ 320 kbps

Programming MP3/WMA Tracks for Playback

You can program up to 99 MP3/WMA tracks for playback in any desired order. Before programming, make sure the system is in STOP mode.

- 1) Set the function selector to USB/SD mode, then press the STOP ■ button.
- 2) Press the PROG button. "MEM" will flash on the LCD display, indicating the program number and the track number to be programmed.
- 3) Press SKIP UP ►► or SKIP DOWN ◀◀ to select the desired track.
- 4) Press the PROG button again to store the selected track in memory.
- 5) Repeat Steps 3 and 4 to program additional tracks.
- 6) After all desired tracks have been programmed, press the PLAY/PAUSE ► button to begin playback in the programmed order.
- 7) To cancel the programmed playback, press the STOP ■ button twice.

Using the CD Player

- 1) Tap the POWER/VOLUME knob to turn the unit on.
- 2) Press the CD EJECT button to open the disc tray.
- 3) Place a CD face up on the tray, making sure it is properly seated.
- 4) Press the CD EJECT button again to close the disc tray. Playback will begin automatically.
- 5) To play a different track, press SKIP UP ►► or SKIP DOWN ◀◀ to select the desired track.
- 6) To adjust the volume level, turn the VOLUME knob clockwise or counterclockwise.

OPERATION

Listening to the Radio

- 1) Tap the POWER/VOLUME knob to turn the unit on.
- 2) Set the function selector to TUNER mode.
- 3) Use the band selector to choose AM or FM.
- 4) Turn the TUNING knob left or right to search for a radio station.
- 5) Continue tuning until the desired station is received clearly.
- 6) Adjust the VOLUME knob to the desired listening level.

Reception Tips:

AM Reception: The unit has a built-in AM bar antenna. If reception is weak, gently rotate or reposition the unit to improve reception.

FM Reception: The unit has a built-in FM wire antenna located at the rear of the cabinet. For best reception, fully extend and unravel the antenna wire.

FM Stereo: When a stereo broadcast is received, the ST indicator will light up on the display.

Auto Scan and Preset Stations:

- 7) Press and hold the PLAY ► button for 3 seconds to automatically search for and store available radio stations.
- 8) To listen to a stored station, press SKIP UP ►► or SKIP DOWN ◀◀ to select the desired preset.
- 9) To manually search for stations, press and hold SKIP UP or SKIP DOWN for 3 seconds to scan upward or downward.
- 10) When finished listening, tap the POWER/VOLUME knob to turn the unit off. Unplug the unit from the power outlet if it will not be used for an extended period.

Using the Record Player (Phono Operation)

- 1) Open the dust cover and tap the POWER/VOLUME knob to turn the unit on.
- 2) Set the function selector to PHONO mode.
- 3) Set the speed selector to the appropriate setting — 33, 45, or 78 RPM — depending on the record being played.
- 4) Set the AUTO STOP control to ON if you want the turntable to stop automatically at the end of the record. If set to OFF, the turntable will continue rotating after playback ends.
- 5) Place the record on the turntable. (Use the 45 RPM adapter if required.)
- 6) Move the lift lever toward the back to raise the tone arm from the arm rest, then carefully move the tone arm over the record. The turntable will begin rotating.
- 7) Move the lift lever forward to gently lower the tone arm onto the record. Playback will begin.
- 8) To stop playback, move the lift lever toward the back to raise the tone arm. The turntable will continue rotating, but playback will stop.
- 9) To play a different track, raise the tone arm using the lift lever, move it to the desired position on the record, then lower it using the lift lever to resume playback.
- 10) Adjust the VOLUME knob to the desired listening level.
- 11) At the end of the record, raise the tone arm using the lift lever, return it to the arm rest, and then lower the lift lever to secure the arm.
- 12) Alternatively, you may manually lift the tone arm and return it to the arm rest.
- 13) When finished, engage the tone arm lock to prevent accidental movement.
- 14) Tap the POWER/VOLUME knob to turn the unit off. Unplug the unit from the power outlet if it will not be used for an extended period.

NOTE:

If the record stops before the final track finishes, set the AUTO STOP control to OFF. The record will then play to the end, but you must stop the turntable manually. Return the tone arm to the arm rest, switch the unit off using the POWER/VOLUME knob if the turntable is still rotating, and then reset the AUTO STOP control to ON.

OPERATION

Listening to an External Device via AUX Input

- 1) Tap the POWER/VOLUME knob to turn the unit on.
- 2) Set the function selector to PHONO/AUX mode, then connect the external audio device (such as a CD player) to the AUX IN socket on the front of the unit. The audio from the external device will now play through the system.
- 3) When an external device is connected to the AUX IN socket, the LCD display will show "AUX".

NOTE: If the unit will not be used for an extended period, it is recommended to remove any CD from the disc tray to prevent damage or warping.

Using the Cassette Player

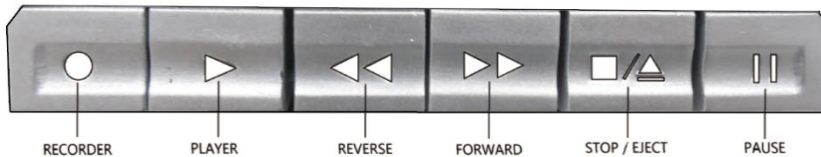

- 1) Press the STOP/EJECT button to open the cassette compartment.
- 2) Insert the cassette tape into the deck, making sure it is oriented correctly.
- 3) Use the cassette control buttons to operate the tape:

- RECORD: Used to record audio from other sources onto the cassette.
- PLAY: Used to play a cassette tape.
- REVERSE: Used to rewind the tape.
- FORWARD: Used to fast-forward the tape.
- STOP/EJECT: Press once to stop playback. Press again to open the cassette compartment and remove the tape.
- PAUSE: Press to pause playback; press again to resume.

Important:

Always insert the cassette in the correct direction.

To avoid damaging the cassette or the player, remove the tape after use.

To prevent accidental erasure of cassette contents, move the anti-erase tabs to the locked position.

To allow recording, move the tabs back to the unlocked position.

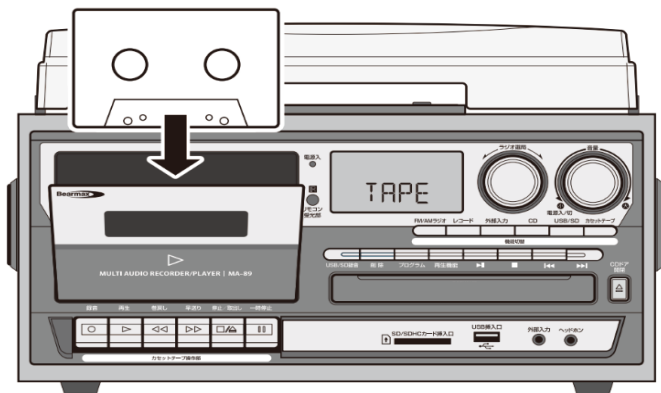

(Anti-erase tape position)

COPYING/ENCODING INSTRUCTIONS

Encoding a Vinyl Record (Phono) to USB/SD

- 1) Set the function selector to PHONO mode, then insert a memory device (USB drive or SD/MMC card).
- 2) Place your record on the turntable and prepare it for playback.
- 3) Press the REC ● button. The system will take 3–4 seconds to read the memory device. The USB or SD icon will begin flashing on the display.
- 4) (Optional) Press SKIP UP ►► or SKIP DOWN ◄◄ to select the desired storage device (USB or SD) for encoding, then press REC ● again to confirm.
 - This step can be skipped if only one memory device is inserted.
- 5) After a few seconds, the system will enter encoding mode.
- 6) Lower the tone arm to start playback of the record. During encoding, the USB or SD icon will continue flashing.
- 7) To stop encoding, press the STOP ■ button. The display will show “END” and the system will return to PHONO mode.

Encoding Cassette to USB/SD

- 1) Set the function selector to TAPE mode, then insert a memory device (USB drive, SD, or MMC card).
- 2) Press the REC ● button. The system will take 3–4 seconds to read the memory device, and the USB or SD icon will start flashing on the display.
- 3) (Optional) Press SKIP UP ►► or SKIP DOWN ◄◄ to select the desired storage device (USB or SD) for encoding, then press REC ● again to confirm.

This step can be skipped if only one memory device is inserted.
- 4) After a few seconds, the system will enter encoding mode. Insert your cassette into the cassette deck. During encoding, the USB or SD icon will continue flashing on the display.
- 5) To stop encoding, press the STOP ■ button. The display will show “END”, and the system will return to TAPE mode.

Encoding a CD to USB/SD

- 1) Set the function selector to CD/USB/SD mode and insert a memory device (USB drive, SD, or MMC card).
- 2) Press the REC ● button. The system will take 3–4 seconds to read the memory device, and the USB or SD icon will start flashing on the LCD display.
- 3) (Optional) Press SKIP UP ►► or SKIP DOWN ◄◄ to select the desired storage device (USB or SD) for encoding, then press REC ● again to confirm.

This step can be skipped if only one memory device is inserted.
- 4) After a few seconds, the system will enter encoding mode. During encoding, the USB or SD icon will continue flashing on the display.
- 5) To stop encoding, press the STOP ■ button. The display will show “END”, and the system will return to CD/USB/SD mode.

COPYING/ENCODING INSTRUCTIONS

Encoding FM/PHONO/AUX to USB/SD

- 1) Set the function selector to FM, PHONO, or AUX mode, then insert a memory device (USB drive, SD, or MMC card).
- 2) Press the REC ● button. The system will take 3–4 seconds to read the memory device, and the USB or SD icon will start flashing on the LCD display.
- 3) (Optional) Press SKIP UP ►► or SKIP DOWN ◄◄ to select the desired storage device (USB or SD) for encoding, then press REC ● again to confirm.
This step can be skipped if only one memory device is inserted.
- 4) After a few seconds, the system will enter encoding mode. During encoding, the USB or SD icon will continue flashing on the display.
- 5) To stop encoding, press the STOP ■ button. The display will show “END”, and the system will return to the selected source mode.

NOTE:

- The recording format is preset to MP3 at 128 kbps.
- Recording occurs in real time (1:1). The recording duration is equal to the playback time of the source.

Encoding to Cassette

- 1) Set the function selector to the desired audio source (AUX, PHONO, FM, CD, USB, or SD).
- 2) Insert a blank or recordable cassette into the cassette deck.
- 3) Play the selected audio source.
- 4) Press the REC ● and PLAY ► buttons on the cassette deck simultaneously to start encoding.
- 5) To stop encoding, press the STOP ■ button.

Copying MP3 / WMA Files

The system allows you to copy files between USB and SD/MMC storage devices. You can copy a single file/track, an entire folder, or all files/tracks on the storage medium.

To Copy a Single File/Track:

- 1) Insert both a USB storage device and an SD/MMC card, then select USB/SD mode as described previously.
- 2) During playback of the track you want to copy, press the REC ● button. The display will flash “ONE”.
- 3) Press the REC ● button again to confirm.
- 4) The USB or SD icon will flash on the display while the system is copying the file.
- 5) Once the copy is complete, playback will stop automatically. The display will show “END”, and the system will return to USB or SD mode.

Copying an Entire Folder

- 1) Insert both a USB storage device and an SD card, then select USB/SD mode as described previously.
- 2) Press the REC ● button. The display will flash “ONE”.
- 3) Press SKIP UP ►► or SKIP DOWN ◄◄ to select “FOL” (Folder) on the display.
- 4) Press the REC ● button again to confirm.
- 5) The USB or SD icon will flash on the display while the system is copying the folder.
- 6) Once the folder has been copied, the USB or SD icon will stop flashing on the display.

COPYING/ENCODING INSTRUCTIONS

To copy all files/tracks:

- 1) Insert a USB storage device and an SD card, then select USB/SD mode (as described previously).
- 2) Press the REC ● (Record) button. "ONE" will flash on the display.
- 3) Press the Skip Up ►► or Skip Down ◄◄ button to select "ALL" on the display.
- 4) Press the REC ● button again to confirm.
- 5) The USB or SD icon will flash on the display while the system copies the files/tracks.
- 6) When all files/tracks have been copied, the USB or SD icon will stop flashing.

Note: If you press the REC ● button during playback in USB or SD mode, the currently playing file will be copied from USB to SD, or vice versa.

Deleting files from aUSB device / SD card

The system can erase files stored on a USB device or SD card. You can delete a single file/track, a folder of files/tracks, or all files/tracks on the storage medium.

To delete a single file/track:

- 1) Insert the USB storage device or SD card, then select USB/SD mode (as described previously).
- 2) During playback of the track you want to delete, press the DEL (Delete) button. "ONE" will flash on the display.
- 3) Press the DEL button again to confirm. "DEL" will appear on the display while the file/track is being deleted. The display will return to normal once deletion is complete.

To delete a folder:

- 1) Insert the USB storage device or SD card, then select USB/SD mode (as described previously).
- 2) Press the DEL (Delete) button. "ONE" will flash on the display.
- 3) Press the Skip Up ►► or Skip Down ◄◄ button to select "DIR" (directory) on the display.
- 4) Press the DEL button again to confirm. "DEL" will appear on the display while the folder is being deleted. The display will return to normal once deletion is complete.

To delete all files/tracks:

- 1) Insert the USB storage device or SD card, then select USB/SD mode (as described previously).
- 2) Once the system has recognized the device, press the Stop ■ button.
- 3) Press the DEL (Delete) button. "ONE" will flash on the display.
- 4) Press the Skip Up ►► or Skip Down ◄◄ button to select "ALL" on the display, then press the DEL button again to confirm.
- 5) While the system is deleting the files/tracks, the USB or SD icon will flash on the display. The icon will stop flashing once deletion is complete.

Note: Pressing the DEL button in this mode will permanently delete all files/tracks on the USB device or SD card.

COPYING/ENCODING INSTRUCTIONS

AUX IN Encoding

- 1) Use the function selector to select PHONO/AUX mode, then insert a memory device (USB drive, SD card, or MMC card).
- 2) Press the REC ● (Record) button. The system will take approximately 3–4 seconds to read the memory device, after which the USB or SD icon will flash on the LCD display.
- 3) Press the Skip Up ►► or Skip Down ◄◄ button to select the desired encoding destination (USB or SD), then press the REC ● button again to confirm.
- 4) (Skip this step if only one memory device is inserted.)
- 5) After a few seconds, the system will start encoding. During encoding, the USB or SD icon will flash on the display.
- 6) To finish encoding, press the Stop ■ button. The display will show “END” and then return to PHONO/AUX mode.

Note:

- The recording speed is 1:1. Recording time will match the playback time of the source (CD or other auxiliary input).
- The recording format is preset to MP3 with a bit rate of 128 kbps.

TROUBLESHOOTING GUIDE

If you are experiencing problems with your USB Turntable with Cassette Deck and Radio, check the section below for quick and easy steps that may help resolve the issue. If the problem cannot be solved, contact our after-sales support line for assistance. Do not attempt to open, repair, or modify the equipment yourself.

Problems with Sound

- Tap the POWER/VOLUME knob to turn the unit on, then rotate the POWER/VOLUME knob clockwise to increase the volume.
- Ensure the power cord is securely connected to an appropriate electrical outlet.
- Make sure the wall socket is switched on.
- Confirm the function selector is set to the desired mode: PHONO, USB/SD, TUNER, or PHONO/AUX.
- When playing records, ensure the correct speed is selected (33, 45, or 78 rpm).
- When playing a cassette, make sure it is properly inserted.
- When playing a CD, ensure the disc is placed face up.
- When playing a CD via the AUX IN connection, make sure the cable is firmly connected, all controls on the CD player are properly set, the disc tray is closed, and the disc is clean and undamaged.
- When playing music from a USB device or SD/MMC card, ensure the memory device is properly inserted into the USB port or SD/MMC card slot and that the correct mode is selected.

Problems with Radio Reception

- Make sure you are in an area that can receive signals for the selected radio station.
- If AM reception is weak, rotate or reposition the unit to improve reception.
- If FM reception is weak, try the following:
 - Fully extend the wire antenna located at the back of the unit.
 - Adjust the position of the wire antenna for better reception.
- If stereo FM reception remains poor, try tuning the same station in FM (mono) mode.
- Move the radio to a different location to see if reception improves.
- Ensure there is no other electrical equipment nearby that may cause interference.

MAINTENANCE

Maintaining the Turntable Needle (Stylus)

To extend the life of the stylus, gently clean it occasionally using a very soft brush lightly dipped in rubbing alcohol. Brush only from the back toward the front of the cartridge to avoid damaging the stylus.

Maintaining Vinyl Records

To maximize sound quality and extend the life of your vinyl records, clean them with an anti-static cloth after each use.

Transporting the Turntable

Before transporting the unit, follow these steps:

- 1) Place the protective cap on the stylus.
- 2) Secure the pick-up arm using the arm rest clip.
- 3) Ensure the lid is closed and the latch is securely fastened.

Installing or Replacing the Stylus

The stylus must be replaced periodically. It is recommended to replace the stylus after approximately 250 hours of playback. To install a new stylus or replace the existing one, follow the steps below:

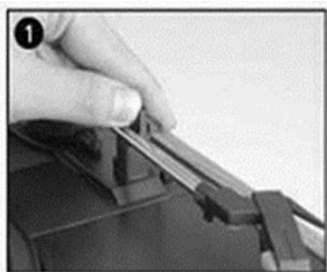

Push the arm lock to release the tone-arm.

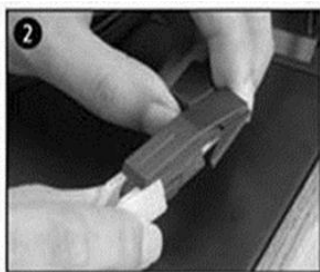

Remove the cartridge cap to expose the needle.

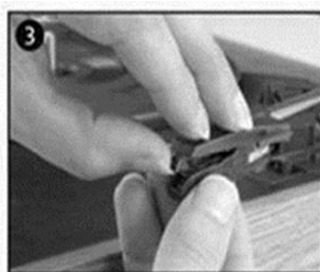

Gently separate the cartridge from the socket.

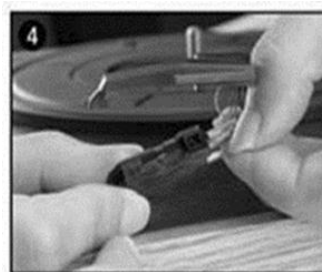

Remove the audio-line from the cartridge.

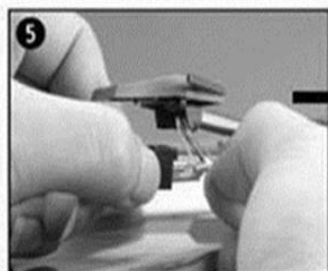

Align the audio-line with the new cartridge.

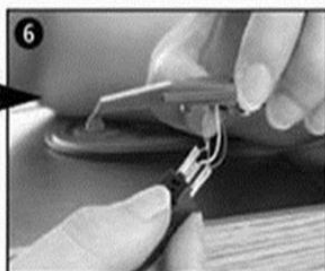

Insert the audio-line into the new cartridge.



Gently insert the cartridge into the socket.

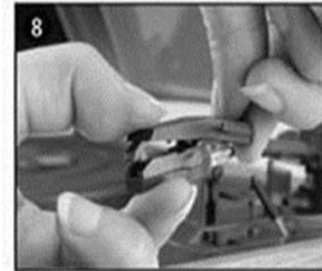

Attach the cartridge cap.

NOTE: Please exercise extreme care when performing this operation to avoid damaging the tone arm or audio line wires.

MAINTENANCE

Re-Attaching the Turntable Drive Belt

If the turntable platter does not rotate, the drive belt may have become detached. Follow the steps below to re-attach the turntable drive belt.

Step 1

Remove the turntable anti-slip mat from the platter. Through one of the holes in the platter, check whether the drive belt has come off the motor pulley.

Using a screwdriver, carefully remove the black metal C-clip (retaining clip), then lift the platter off the turntable mechanism.

Step 2

Locate the detached black rubber drive belt and place it around the inner rim of the platter. Gently pull a section of the belt outward from underneath the platter, taking care not to overstretch it.

While holding the belt in place, turn the platter upside down.

Step 3

Through one of the holes in the platter, locate the small brass pulley attached to the turntable motor. Carefully hook the exposed section of the drive belt around the pulley by hand.

Align the center hole of the platter with the silver turntable spindle, then lower the platter gently into position.

Step 4

Once the platter is seated correctly, check that the drive belt remains properly positioned around the pulley. Reinstall the C-clip to secure the platter to the spindle.

Step 5

Replace the turntable anti-slip mat on the platter. Turn on the unit and operate the turntable normally to confirm that the platter now rotates correctly.

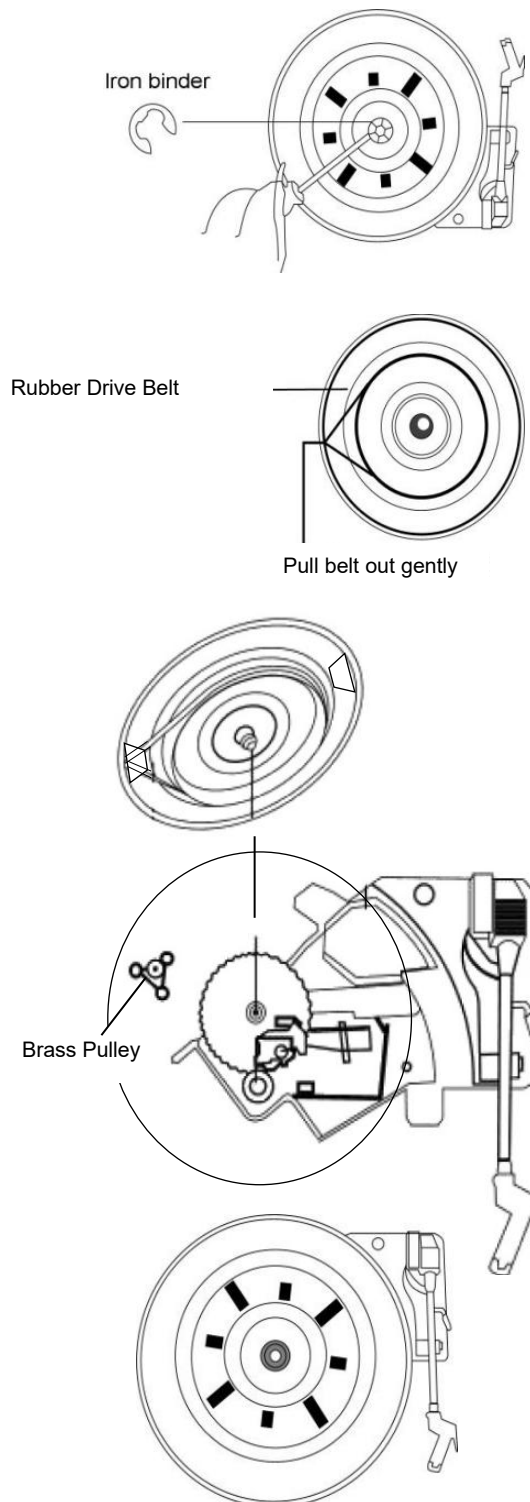

FCC NOTICE

This device complies with Part 15 of the FCC Rules. Operation is subject to the following two conditions: (1) this device may not cause harmful interference, and (2) this device must accept any interference received, including that may cause undesired operation.

NOTE: This equipment has been tested and found to comply with the limits for a Class B digital device, pursuant to Part 15 of the FCC Rules. These limits are designed to provide reasonable protection against harmful interference in a residential installation. This equipment generates, uses, and can radiate radio frequency energy and, if not installed and used in accordance with the instructions, may cause harmful interference to radio communications. However, there is no guarantee that interference will not occur in a particular installation. If this equipment does cause harmful interference to radio or television reception, which can be determined by turning the equipment on and off, the user is encouraged to try to correct the interference by one or more of the following measures:

- Reorient or relocate the receiving antenna.
- Increase the separation between the equipment and receiver.
- Connect the equipment into an outlet on a circuit different from that to which the receiver is connected.
- Consult the dealer or an experienced radio/TV technician for help.

IC STATEMENT

This device complies with RSS247 of Industry Canada. Cet appareil se conforme à RSS247 de Canada d'Industrie. This device complies with Industry Canada license-exempt RSS standard(s). Operation is subject to the following two conditions: (1) this device may not cause interference, and (2) this device must accept any interference, including interference that may cause undesired operation of the device. appareils radio exempts de licence.

Son fonctionnement est sujet aux deux conditions suivantes: (1) le dispositif ne doit pas produire de brouillage préjudiciable, et (2) ce dispositif doit accepter tout brouillage reçu, y compris un brouillage susceptible de provoquer un fonctionnement indésirable.

The device must not be co-located or operating in conjunction with any other antenna or transmitter.

L'appareil ne doit pas être localisé ou fonctionner avec d'autres antennes ou transmetteurs.

This device complies with IC radiation exposure limits set forth for an uncontrolled environment.

Cet appareil est conforme aux limites d'exposition aux rayonnements de la IC établies pour un incontrôlé environnement.

The device should be installed and operated with a minimum distance of 20cm between the radiator and your body.

L'appareil doit être installé et utilisé avec une distance minimale de 20 cm entre le radiateur et votre corps.

CAUTION ON MODIFICATIONS



Any changes or modifications to this device that are not expressly approved by the manufacturer may void the authority granted by the FCC to operate the equipment.

Electric and electronic equipment contain materials, components, and substances that can be hazardous to both your health and the environment if not disposed of properly. Such equipment is marked with a crossed-out trash can symbol, shown below.

This symbol indicates that the equipment must not be disposed of with regular household waste. Instead, it should be collected and disposed of separately.

Most cities provide designated collection points where electric and electronic equipment can be submitted free of charge at recycling stations or other authorized collection sites. In some areas, collection from households may also be available.

For additional information, contact the technical department of your local municipality.

SUPPORT

We do our best to offer high quality products to our customers. If you experience any issues or problems with your product, please contact customer support as many issues can be quickly resolved.

If you have problems with your device, please consult the instructions in this manual. Please also visit us on the web at www.victoraudio.com to get up to the minute news, alerts, and documentation for your device. For additional assistance, please contact RCA Victor Technical Support.

RCA VICTOR Technical Support

2320 East 49th Street

Vernon, CA 90058

Tel: (866) 411-6292

Email: support@victoraudio.com

Made in China

**This product has been manufactured and sold under the responsibility of NAXA ELECTRONICS INC.*

[RCA VICTOR and the RCA VICTOR Logo]/[VICTOR and the DOG & GRAMOPHONE Logo] are trademarks used under license by NAXA ELECTRONICS INC.

All other products, services, companies, trademarks, trade or product names and logos referenced herein are the property of their respective owners.